

STARLIGHT SCHOOL PLAYGROUND
New Philadelphia, Ohio

5/6/2024

ADDENDUM NO. 1

TO THE DRAWINGS AND SPECIFICATIONS FOR:
PROJECT NO. 240117.000

TO ALL BIDDERS:

This Addendum supplements and amends the original Plans and Specifications and shall be taken into account in preparing proposals and shall become a part of the contract documents.

ITEM 1

LEGAL NOTICE: Bid Opening is changed from Friday, May 10, 2024 at 10:00 AM, to Wednesday May 15, 2024 at 11:00 AM.

ITEM 2

Under Section M of the Invitation to Bidders, the deadline to submit questions is extended to Thursday, May 9, 2024 at 12 noon.

ITEM 3

TABLE OF CONTENTS:

- Delete "01 11 16.....Invitation to Bid."
- Delete "00 26 00.....Procurement Substitution Procedures."
- Delete "00 43 23.....Alternates Forms."
- Under Division 03, it should read "03 30 00 Cast-in-Place Concrete."
- Under Division 05, it should read "05 52 13 Pipe and Tube Railings."

ITEM 4

SHEET L100: The construction note pointing at the tunnel should reference construction note 19, not 2.

ITEM 5

Attached is the sign-in sheet for those in attendance at the pre-bid meeting held on May 2, 2024.

ITEM 6

Question: Are the documents available on QUESTCDN, and what is the project number if so?

Answer: No, the documents are not on QUESTCDN.

END OF ADDENDUM

Addendum No. 1

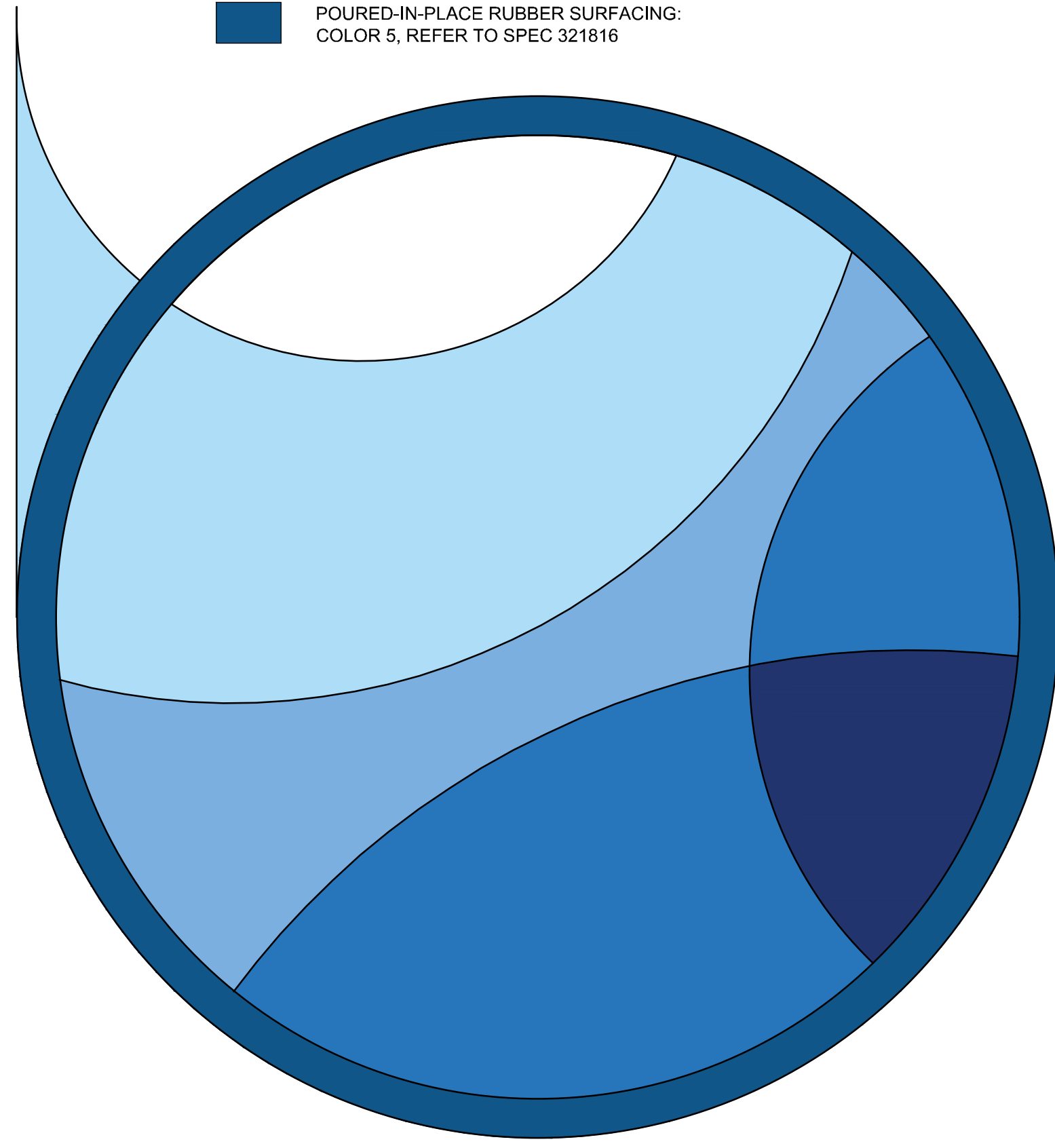

1 POURED-IN-PLACE RUBBER SURFACING PATTERN
SCALE: 1" = 10'-0"

- NOTES:**
- SEE SPECIFICATION 321816 FOR ADDITIONAL INFORMATION.
 - LAYOUT IN FIELD AND OBTAIN LANDSCAPE ARCHITECT'S APPROVAL PRIOR TO INSTALLATION.

LEGEND:

- POURED-IN-PLACE RUBBER SURFACING: COLOR 1, REFER TO SPEC 321816
- POURED-IN-PLACE RUBBER SURFACING: COLOR 2, REFER TO SPEC 321816
- POURED-IN-PLACE RUBBER SURFACING: COLOR 3, REFER TO SPEC 321816
- POURED-IN-PLACE RUBBER SURFACING: COLOR 4, REFER TO SPEC 321816
- POURED-IN-PLACE RUBBER SURFACING: COLOR 5, REFER TO SPEC 321816

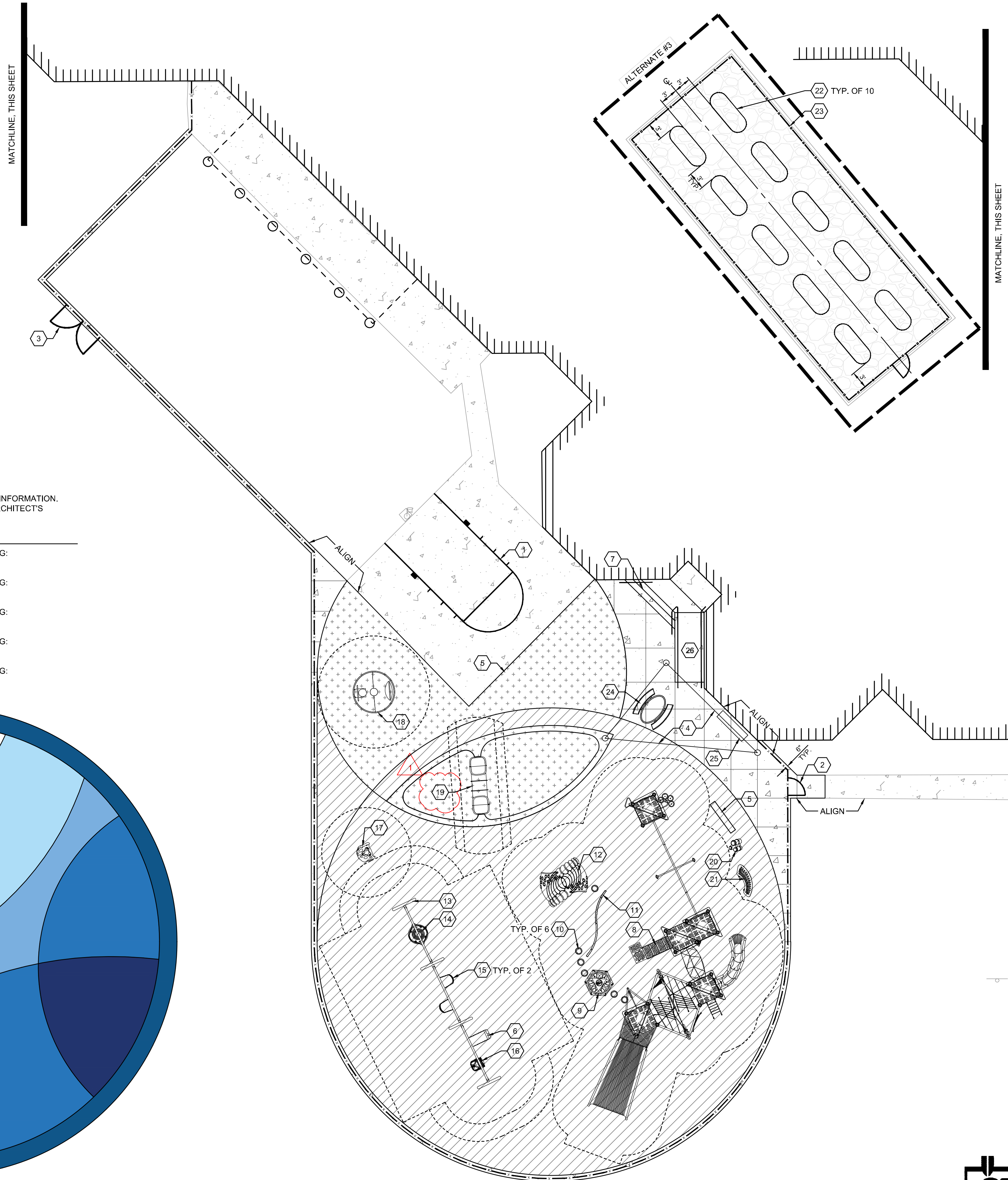

GENERAL NOTES

- EACH CONTRACTOR IS RESPONSIBLE FOR LOCATING AND PROTECTING ALL EXISTING UTILITIES.
- SUBSURFACE IMPROVEMENTS SHALL BE OBSERVED. THE CONTRACTOR SHALL CONTACT THE OHIO UTILITIES PROTECTION SERVICE (OUPS) 48 HOURS PRIOR TO ANY EXCAVATION OR DIGGING TO ENSURE THE LOCATION OF UNDERGROUND UTILITIES. IT SHALL BE THE CONTRACTOR'S RESPONSIBILITY TO PROTECT SUCH UNDERGROUND UTILITIES.
- ALL CONCRETE FORMS SHALL BE FIELD STAKED AND APPROVED BY OWNER'S REPRESENTATIVE PRIOR TO CONCRETE INSTALLATION.
- ALL HORIZONTAL AND VERTICAL LAYOUT SHALL BE REVIEWED BY THE OWNER'S REPRESENTATIVE TO ENSURE GENERAL CONFORMANCE PRIOR TO CONSTRUCTION.
- PROVIDE ISOLATION JOINT WHERE CONCRETE PAVING ABUTS BUILDINGS, COLUMNS, AND STRUCTURES. VERIFY COLOR OF SEALANT WITH OWNER'S REPRESENTATIVE.
- CONTRACTOR SHALL NOT WILLFULLY PROCEED WITH CONSTRUCTION AS DESIGNED WHEN IT IS OBVIOUS THAT UNKNOWN OBSTRUCTIONS, AREA DISCREPANCIES AND/OR GRADE DIFFERENCES EXIST THAT MAY NOT HAVE BEEN KNOWN DURING DESIGN. SUCH CONDITIONS SHALL BE IMMEDIATELY BROUGHT TO THE ATTENTION OF THE OWNER'S REPRESENTATIVE. THE CONTRACTOR SHALL ASSUME FULL RESPONSIBILITY FOR ALL NECESSARY REVISIONS DUE TO FAILURE TO GIVE SUCH NOTIFICATIONS.
- CONTRACTOR SHALL BE RESPONSIBLE TO CONSULT WITH SITE SUPERINTENDENT, APPROPRIATE AGENCIES, AND PLANS FOR LOCATION OF ALL UNDERGROUND UTILITIES, PIPES, AND STRUCTURES.
- CONTRACTOR TO REPORT TO ENGINEER ANY ADDITIONAL UTILITY LINES FOUND DURING CONSTRUCTION.

MATERIAL LEGEND

- 1 L/400 CONCRETE PAVEMENT SEE SPEC 321313
- 2 L/400 POURED-IN-PLACE PLAYGROUND SURFACING SEE SPEC 321816
- 3 L/400 SYNTHETIC TURF PLAYGROUND SURFACING SEE SPEC 321813
- 5 L/400 ANTI-CLIMB FENCE, SEE SPEC 323100

CONSTRUCTION NOTES:

- STRIPE BASKETBALL COURT, SEE DETAIL 4 / L400
- 3' WIDE SINGLE SWING GATE, SEE SPEC 323100
- 8' WIDE DOUBLE SWING GATE, SEE SPEC 323100
- SHADE STRUCTURE, SEE SPEC 133100 (ALTERNATE #1)
- REINSTALL SALVAGED POST AND PANEL SIGN
- INFANT BUCKET SWING, SEE SPEC 116800
- STAIRS AND HANDRAIL, SEE DETAIL 6 / L400
- PLAY STRUCTURE, SEE SPEC 116800
- PLAYCUBE, SEE SPEC 116800
- BUTTON, SEE SPEC 116800 (ALTERNATE #2)
- CURVED BALANCE BEAM, SEE SPEC 116800 (ALTERNATE #2)
- MOON ROCK CLIMBER, SEE SPEC 116800 (ALTERNATE #2)
- ARCH SWING, SEE SPEC 116800
- UNITY BASKET SWING, SEE SPEC 116800
- BELT SWING, SEE SPEC 116800
- ACCESSIBLE SWING SEAT, SEE SPEC 116800
- COZY COCOON, SEE SPEC 116800 (ALTERNATE #2)
- SPIN STATION, SEE SPEC 116800
- TUNNEL, SEE SPEC 116800
- CONCERTO FIVE CONGOS, SEE SPEC 116800
- CONCERTO VIBES, SEE SPEC 116800
- RAISED GARDEN BED, SEE DETAIL 1 / L401
- GARDEN FENCE, SEE DETAIL 2 / L401
- TABLE, SEE SPEC 323300
- BENCH, SEE SPEC 323300
- RAMP AND HANDRAIL, SEE DETAIL 3 / L401

NOTE:
UNDERGROUND UTILITIES ARE PLOTTED FROM A COMPILATION OF AVAILABLE RECORD INFORMATION AND SURFACE INDICATIONS OF UNDERGROUND STRUCTURES AND MAY NOT BE INCLUSIVE. PRECISE LOCATIONS AND THE EXISTENCE OR NON EXISTENCE OF UNDERGROUND UTILITIES CANNOT BE VERIFIED. PLEASE NOTIFY THE OHIO UTILITY PROTECTION SERVICE AT 811 OR 1-800-362-2764 BEFORE ANY PERIOD OF EXCAVATION OR CONSTRUCTION ACTIVITY.



THE KLEINGERS GROUP

CIVIL ENGINEERING SURVEYING LANDSCAPE ARCHITECTURE

www.kleingers.com
350 Worthington Rd
Suite H
Westerville, OH 43082
614.882.4311

SEAL:

| | | |
|-----|------------|---------------|
| NO. | DATE | DESCRIPTION |
| 1 | 04.24.2024 | BID DOCUMENTS |
| | 05.06.2024 | ADDENDUM 1 |

| | |
|--------------|------------|
| PROJECT NO.: | 240117.000 |
| DATE: | 04.24.2024 |
| SCALE: | |

STARLIGHT SCHOOL PLAYGROUND
NEW PHILADELPHIA, OHIO

SHEET NAME:
MATERIAL & LAYOUT PLAN

SHEET NO.
L100

Attendance Roster

Project: Starlight School Playground Renovation
 Project No. 240117.000

Pre-bid meeting and walk
 Date / Time: 05.02.2024 @ 11:00am

| Name (print clearly) | Company | Phone | Email |
|----------------------|----------------------|--------------|--------------------------------|
| Michael Pistolas | Kleingers | 614-882-1143 | michael.pistolas@kleingers.com |
| Eric Hinkle | Midstates Recreation | 614-580-9708 | Eric.H@MidstatesRecreation.com |
| Drew Lilly | TuscBDD | 330-260-8849 | d.lilly@TUSCBDD.ORG |
| Nate Kamban | " | 330-260-8141 | n.kamban@tuscbdd.org |
| Ashley Daugherty | " | 330-556-1021 | adaugherty@tuscbdd.org |
| | | | |
| | | | |
| | | | |
| | | | |
| | | | |
| | | | |
| | | | |
| | | | |
| | | | |
| | | | |